

W65 / W85 NON-SLAM DIVERT VALVE

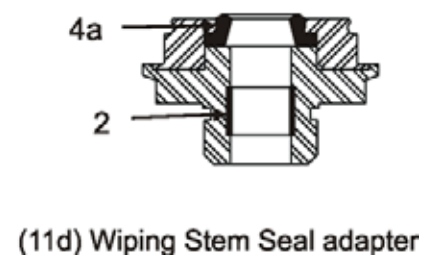
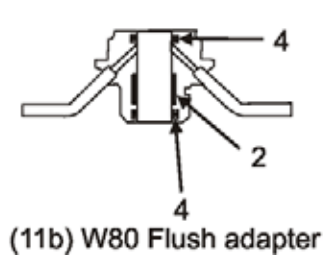
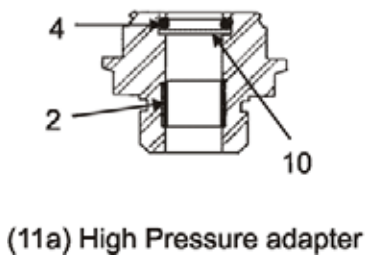
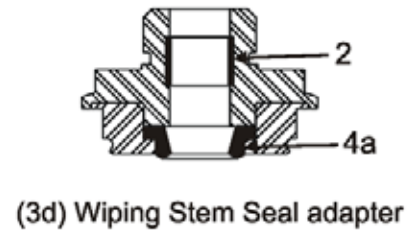
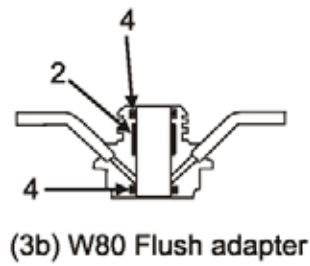
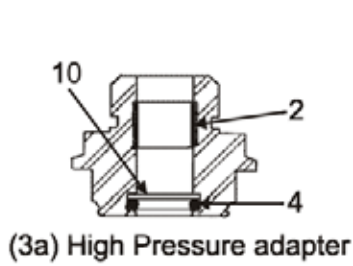
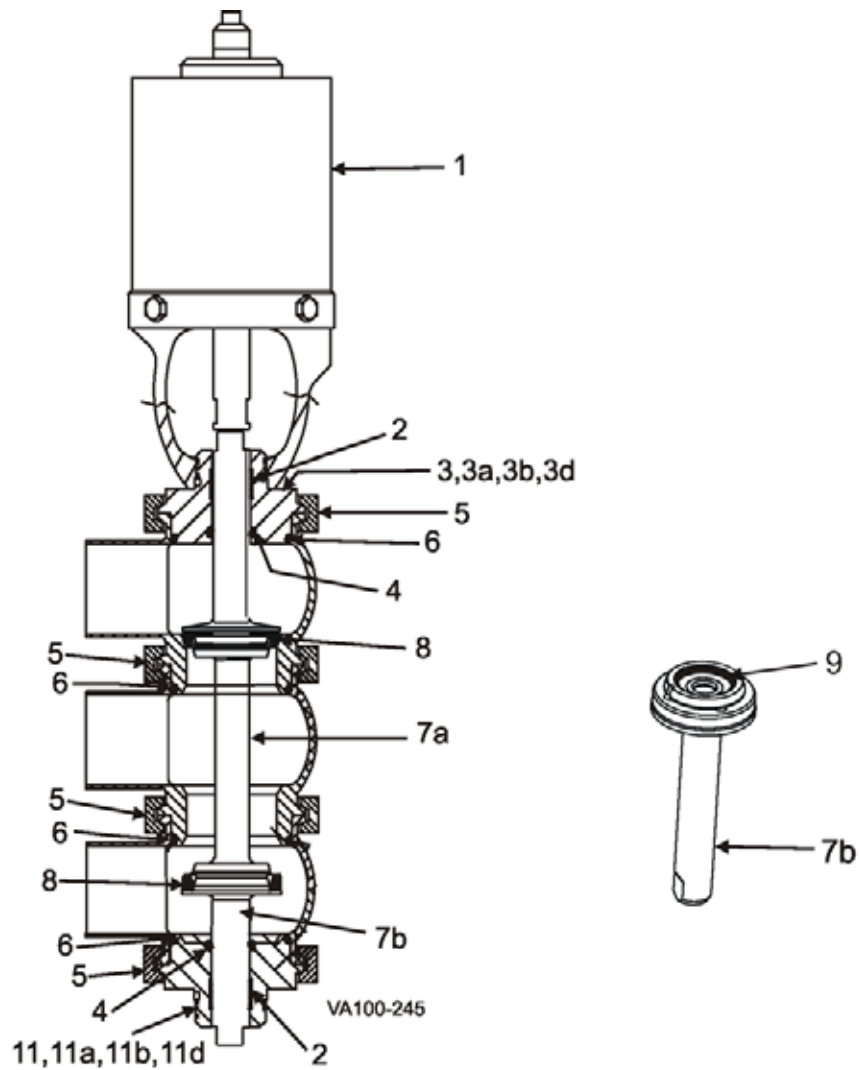

W65 / W85 NON-SLAM DIVERT VALVE

Item #	Part Description	1"	1-1/2"	2"	2-1/2"	3"	4"
	Control Top	Contact Factory					
1	Actuator	See Pages 42-62					
* 2	Bearing	102757	102757	102757	102757	102757	102757
3	Adapter, Upper - W60 (Std.)	102406	102406	102407	102408	102409	102410
3a	Adapter, Upper - High Pressure	W60 109293	109293	109294	109295	N/A	N/A
		W80 116925	116925	116926	116927	N/A	N/A
3b	Adapter, Upper - W80 ²	106291	106291	106292	106293	106294	106295
3d	Adapter, Upper - Wiping Stem Seal ¹	117879	117879	117880	117881	117882	117883
* 4	O-ring	EPDM E70210	E70210	E70210	E70210	E70210	E70210
		FKM V70210	V70210	V70210	V70210	V70210	V70210
* 4a	Wiping Stem Seal¹	EPDM 116183	116183	116183	116183	116183	116183
		FKM 115626	115626	115626	115626	115626	115626
5	Clamp	Standard 119-30	119-30	119-33	119-34	119-51	119-87
		High Pressure ³ 119-271	119-271	119-272	119-273	N/A	N/A
* 6	O-ring, Body	EPDM E70223	E70223	E70228	E70232	E70236	E70244
		FKM V70223	V70223	V70228	V70232	V70236	V70244
7a	Stem, Upper (less seat ring)	Tef-Flow TM 106267	106224	106225	106226	106227	106228
		Tef-Flow TM , Long Stroke N/A	N/A	N/A	110971	110973	110975
		Tri Ring 108160	108161	108162	108163	108164	108165
		Tri Ring, Long Stroke N/A	N/A	N/A	110992	110993	110994
		Metal 108036	108037	108038	108039	108040	108041
		Metal, Long Stroke N/A	N/A	N/A	111007	111008	111009
7b	Stem, Lower (less seat ring)	Tef-Flow TM 106244	106244	106245	106246	106247	106248
		Tri Ring 108166	108166	108167	108168	108169	108170
		Metal 106286	106286	108042	108043	108044	108045
* 8	Seat Ring	Tef-Flow TM 20-240	20-240	20-241	20-242	20-243	20-244
		Tef-Flow TM P 115347	115347	115348	115349	115350	115351
		Tri Ring, EPDM 107692	107692	107695	107048	102488	107698
		Tri Ring, FKM 107983	107983	107986	107982	107974	107989
* 9	O-ring, Lower Stem	EPDM E70206	E70206	E70215	E70215	E70215	E70215
		FKM V70206	V70206	V70215	V70215	V70215	V70215
10	High Pressure Backup Ring	BUR210	BUR210	BUR210	BUR210	N/A	N/A
11	Adapter, Lower - W60 (Std.)	106329	106239	106240	106241	106242	106243
11a	Adapter, Lower - High Pressure	W60 103632	103633	103634	103635	N/A	N/A
		W80 116930	116931	116932	116933	N/A	N/A
11b	Adapter, Lower - W80 ²	106328	106296	106297	106298	106299	106300
11d	Adapter, Lower - Wiping Stem Seal ¹	117979	117980	117981	117982	117983	117984

PL5027-CH8

NOTES:

* Recommended Spare Parts

1. Wiping stem seal adapter and wiping stem seal options available for W60 series valves only.
2. W80 adapter allows for liquid or steam flush of stem o-ring.
3. High pressure body clamp only required for valves equipped with high pressure adapter (item 3a).

