



# ITT

Provided by:

**Holland**<sup>®</sup>  
**APPLIED TECHNOLOGIES**  
[www.hollandapt.com](http://www.hollandapt.com)  
Phone: 800-800-8464

Pure-Flo<sup>®</sup>

## Integral Horizontal Sterile Access (IHSA)

The Integral Horizontal Sterile Access (IHSA) is designed for sterile access applications where the piping for the main valve and purge valve are both on a horizontal plane. The IHSA provides additional benefits over standard Horizontal Sterile Access (HSA) fabrications. The IHSA should be used whenever optimal drainability and minimal deadlegs are required in horizontal orientations.

### Typical Applications:

- Integral block incorporating second horizontal valve
- Ideal for vertical space constraints

### Specifications

Standard Sizes:

- 0.5" - 4" (DN15 - 100)
- Other sizes available upon request

Materials:

- 316L ASTM - A479
- DIN 177440, 1.4435
- Other materials available upon request

Standard End Connections:

- 14, 16, 18, 20 Gauge OD tubing
- DIN/ISO
- Tri-Clover Tri-Clamp<sup>®</sup>
- Others available upon request

Compatible with standard Pure-Flo topworks: See PFTOP for details on available manual bonnets or actuator.

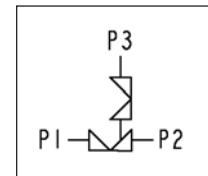
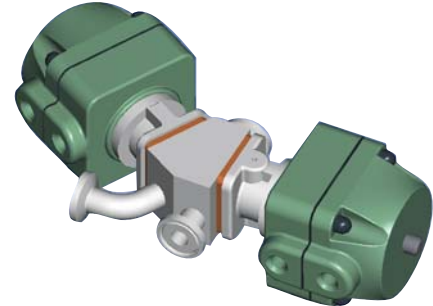

Flow Path

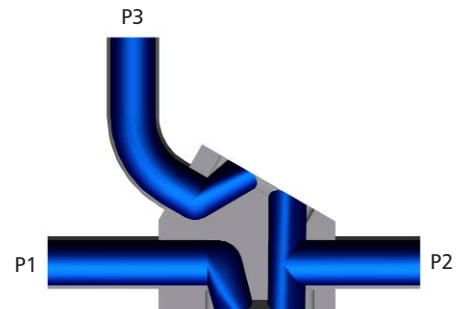

*Engineered for life*



# ITT

## Pure-Flo®

### How to Order a Integral Horizontal Sterile Access

Integral Horizontal Sterile Access valve with a 1" wrought stainless steel body, all outlets have buttweld ends, 25 Ra interior finish, standard exterior finish (Scotch Brite).

**Figure Number:** IHSA-1-428-1-428-W-6-1-0

Configuration Example		IHSA	1		428	1		428	W	6-1-0
Valve Body	Block Type	IHSA								
	Valve Size		1							
	Type (.5" only) <sup>1</sup>									
	End Connections (P1, P2)				428					
	Second Valve Size					1				
	Second Valve Type (.5" only) <sup>1</sup>									
	Second Valve End Connection (P3)							428		
	Body Material								W	
	Polish Selections									6-1-0

<sup>1</sup> For .5 inch valve, must specify Pure-Flo (PF) or Bio-Tek (BT).

To add topworks, see BBTOP-07. For additional figure numbers, see PFORD.

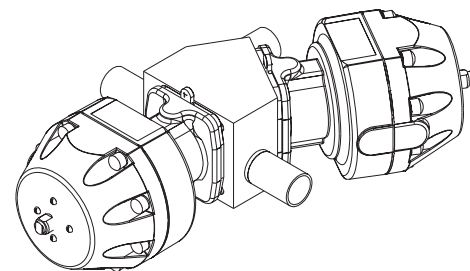
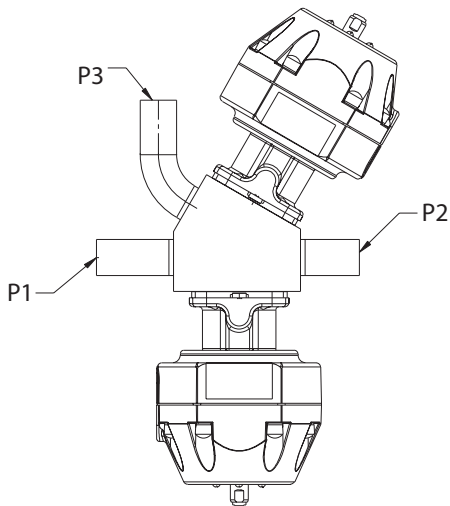

ISOMETRIC VIEW

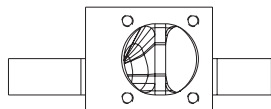

FRONT VIEW

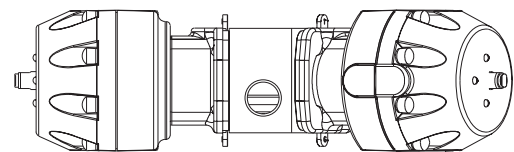

SIDE VIEW

Please contact Pure-Flo CA at 805-520-7200 for the latest drawing and dimensional information. The above drawing should only be used as a general reference.

© 2007 ITT Corporation  
Industrial Process

IHSA-07

Provided by:

**Holland®**  
**APPLIED TECHNOLOGIES**  
[www.hollandapt.com](http://www.hollandapt.com)  
Phone: 800-800-8464

ITT Pure-Flo  
33 Centerville Road  
Lancaster, PA 17603  
(717) 509-2200  
[www.ittpureflo.com](http://www.ittpureflo.com)